



# NIMROD | Stick Vacuum Cleaner



**(EN) User manual**  
Rechargeable handheld  
and upright vacuum cleaner



## Table of Contents

<b>General</b>	
General.....	3
Information on the manual.....	3
Liability.....	3
Notices in the user manual.....	3
<b>Safety warnings</b>	
CE Declaration of Conformity.....	4
Intended Use.....	4
Using against instructions.....	4
WARNING! Children.....	5
Attention! Electrical current.....	6
Transferring.....	8
In case of failure.....	16
<b>Overview</b>	
Scope of delivery.....	9
Technical information.....	10
<b>Assembly</b>	
Unpacking.....	11
Assembly.....	11
Charging the battery / Wall mount.....	12
<b>Operation</b>	
Operation.....	13
Accessory.....	13
<b>Cleaning and maintenance</b>	
Cleaning.....	14
Emptying the dust cup.....	15
Changing EPA filter.....	15
Cleaning the electric power brush.....	18
<b>Troubleshooting</b> .....	<b>16</b>
<b>Recycling</b> .....	<b>18</b>
<b>Warranty</b> .....	<b>19</b>
<b>Notes</b> .....	<b>20</b>

**Information on the manual**

Thank you for purchasing the **Victor** rechargeable Stick vacuum cleaner. It was designed and constructed for many years of trouble-free operation.

**Liability**

This user manual is intended to ensure safe and proper handling and operation of the appliance. Read this user manual carefully before using the appliance for the first time. Keep the user manual in a safe place. Include this user manual when passing the appliance on to another user.

We will accept no liability for damages resulting from failure to comply with the user manual.

We cannot assume any liability in case the appliance is used for other purposes than its intended use or handled, repaired or serviced improperly.

**Notices in the user manual****WARNING!**

Indicates notices which, if ignored, can result in risk of injury or death.

**CAUTION!**

Indicates notices of risks that can result in damage to the appliance.

**NOTE!**

Specifies tips and other useful information in the user manual.

**CE Declaration of Conformity**

This appliance fulfils the requirements of the Product Safety Law -ProdSG-, as well as the EU Directives 2014/30/EU "Electromagnetic Compatibility", 2014/35/EU "Low-Voltage Directive", 2001/95/EG "General product safety", 2011/65/EU "RoHS Directive" 2017/1369/EU "Energy Labelling Regulation" and 2009/125/EG "Eco-design Directive".

This appliance bears the CE-Mark on the rating plate. Victor reserves the right to change the design and equipment.

**Intended use**

The Victor rechargeable stick vacuum cleaner is intended primarily for dry vacuuming of indoor areas of buildings.

The rechargeable vacuum cleaner may be used only for household purposes and is designed for light cleaning.

The rechargeable vacuum cleaner is not suitable for commercial use.

Prior to operation, check to make sure that all filters are inserted correctly. Never operate the appliance without filters.

Use only original Victor filters and accessories. Any other use is considered unauthorized and is prohibited.

**Using against instructions**

Using the appliance against the instructions specified above may cause damage to the appliance or personal injuries.



### **WARNING! Children**

- This appliance may be used only by children from the age of 8 years and over, persons with limited physical, sensory or mental capacities or by persons lacking in experience, if they will be supervised, or they have been properly instructed with regard to safe use of the appliance and they are aware of the possible resulting risks.
- Children should not play with this appliance.
- Cleaning and maintenance shall not be carried out by children without supervision.
- Keep plastic packaging foils away from children
  - danger of suffocation!



### **WARNING! Children**

- Children younger than 3 years shall be kept away from the appliance if they are not supervised constantly.
- This appliance may be used by persons (including children) with limited physical, sensory or mental capabilities, or with limited experience and/or knowledge, only under the supervision of a person responsible for their safety, or in accordance with the instructions of that person.
- Children shall be supervised to ensure that they do not play with the appliance.
- Suffocation risk due to packaging foils. This appliance shall not be used for play.
- Children older than 3 years and younger than 8 years may switch the appliance on and off only if they are under supervision or are informed of the safe use of the appliance and if they understand the hazards that may be caused by the appliance. In this respect, it is a prerequisite for the appliance to be in normal usage position or that it is installed properly.
- Children older than 3 years and younger than 8 years shall not plug the appliance to the electrical outlet, adjust the appliance, and do not perform any cleaning or maintenance operations.
- The appliance shall not be used without supervision.

**WARNING! Danger of injury from vacuuming.**

- Never vacuum articles of clothing, hair, eyes, fingers or other parts of the body.
- This appliance is intended only for dry use.
- This appliance is intended only for use and storage indoors.
- Nozzles and tube ends shall never be brought close to the eyes or ears.
- Never use the appliance to vacuum human beings or animals. The manufacturer is not responsible for any damages caused by improper operation of the appliance.

**WARNING!**

This appliance is not suitable for vacuuming of hazardous materials such as toners used in laser printers or copiers.

**WARNING! Risk of electrocution!**

- Never touch the plug with wet hands.
- When unplugging the appliance, always pull directly on the plug and never on the power cord.
- Do not kink, pinch or run over the power cord and do not expose it to heat sources.
- If the power cord of this appliance is damaged, it shall be re-placed by the manufacturer or the manufacturer's customer service department or a person with similar qualifications to prevent any hazards.
- Do not put the appliance in operation if you detect any visible damage on the housing, if the power cord is defective or if you suspect a defect (e.g. after a fall).
- Do not use any damaged power cords.

**WARNING! In case of danger**

In case of danger or an accident, unplug the appliance immediately.



### **WARNING! Risk of fire and explosion!**

- Never vacuum hot ashes or burning objects, such as ciga-rettes or matches.
- Never use the appliance in the vicinity of explosive or flam-mable materials.
- Never vacuum any solvents, explosive gases or liquids.



### **WARNING! Risk of short circuit.**

Never vacuum water and other liquids, such as damp carpet cleaning solutions.



### **WARNING! Damage to the filter.**

Never vacuum sharp or pointed objects, such as glass splin-ters, nails, etc. Materials that harden when dry, such as plas-ter or cement, may also destroy the filter.



### **WARNING! Danger from overheating!**

Always keep the openings on the appliance free.



### **WARNING! Damage to appliance due to rain and dirt may occur!**

Never use or store the appliance outdoors.



### **Attention! Electrical current**

- Incorrect voltage may cause damage to the appliance. Op-erate the appliance only if the voltage specified on the rating plate corresponds to the voltage in your household.
- The outlet used shall be secured with a fuse switch of 10 A.
- Use extension cords designed for the power input of the ap-pliance only.

### Transferring

Pack the appliance with its original package or with similar packaging materials with proper filling to prevent damage to the appliance.

### In case of failure



#### **WARNING!**

Never operate a defective appliance or an appliance with a defective power cord. Risk of electric shock.

Before contacting our Hotline, check to see if you can eliminate the problem yourself.



#### **Note!**

Please contact our Hotline first, if you cannot troubleshoot a problem by yourself or in case of an intentional product return.

#### **Hotline**

**0121 706 5771**

Always keep the serial number of the product and appliance/model name at hand before calling. You may find these information on the type label of the appliance.



#### **WARNING!**

Repairs and maintenance shall be carried out only by trained specialists (e.g. an authorized Victor service center). Use genuine Victor replacement parts for these procedures. Appliances that are repaired by unauthorized persons or that are not maintained properly pose a risk for the user.



Scope of delivery

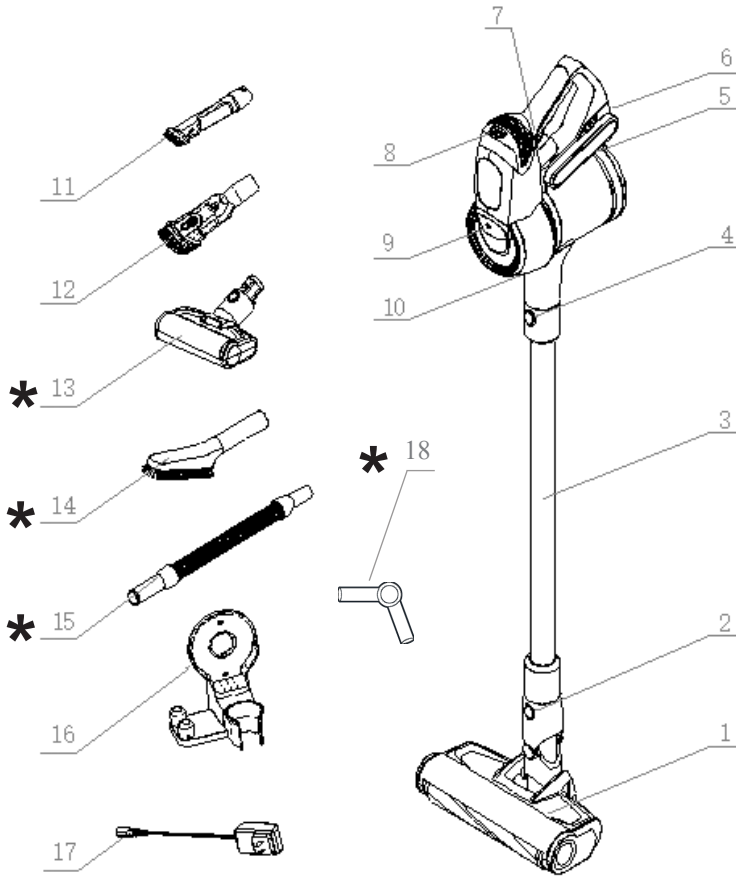

- |                                |                                 |
|--------------------------------|---------------------------------|
| 1. Electric power brush        | 10. Dust cup release button     |
| 2. Brush release button        | 11. 2 in 1 flat brush           |
| 3. Conductive metallic tube    | 12. 2 in 1 sofa brush           |
| 4. Tube release button         | 13. Small electric power brush* |
| 5. Battery pack assembly       | 14. Soft brush*                 |
| 6. Battery pack release button | 15. Flexible hose*              |
| 7. On/Off                      | 16. Wall mount                  |
| 8. Speed control               | 17. Charger                     |
| 9. EPA filter                  | 18. Joint adapter*              |

\*Optional accessory, not included.

## Technical information

Model	Victor Stick Vacuum Cleaner
Ref.-Nr.:	29 72 003
Akku	Li-Ion 24 V / 2500 mAh 4-5 h
Charging time	2
Suction stage	380 W
Motor	15 kPa
Vacuum	0,4 l
Dust capacity	ca. 10 / 35 min
Running time high/low	125 x 25,5 x 21,5 cm 2,3 kg
Dimension HxB	220-240 V ~50/60 Hz
Weight	
Rated voltage charger	

### High level

Suction capacity at the nozzle: 74,6 W

Max. air flow: 15,86 l/s

Max. vacuum: 16,39 kPa

### Low level

Suction capacity at the nozzle: 13,69 W

Max. air flow: 9,57 l/s

Max. vacuum: 7,02 kPa

## Unpacking

Unpack the appliance and check the contents for completeness (see "scope of delivery").  
If you notice any transportation damage, please contact your dealer immediately.

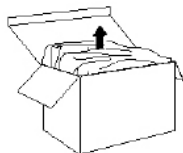

### Note!

Keep the packaging material for storage or transfer of the appliance (e.g. changing household, service operations).



### Warning!

Never use a faulty appliance.

## Assembly

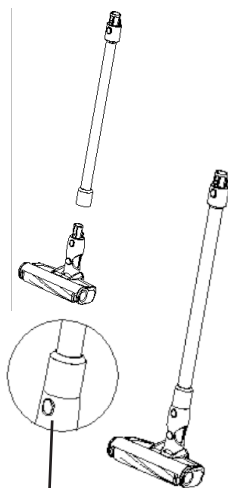

Release button

Connect the tube with the nozzle until you hear a click sound. To separate the parts, press the release button and pull out the tube.

### Installation of the dust cup:

Hold the hand-held vacuum cleaner handle, align the dust cup limit slot with the dust cup limit hook, then rotate the dust cup counterclockwise into the hand-held vacuum cleaner until you hear the click lock sound. To remove the cup, press the release button, rotate the cup clockwise and pull out the cup.

### Installation of the battery pack:

Shove the battery pack at the guide rail slot towards the cleaner, and then fasten the battery cover in the arrow direction as shown in the illustration.

To remove the battery pack, press the release button and pull out the pack.

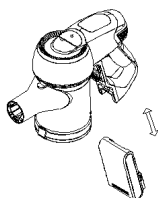
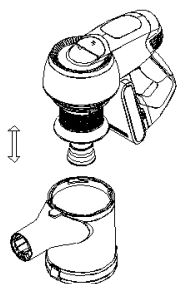

Finally push the metallic tube into the hand-held vacuum cleaner until you hear a click sound, now the installation is finished.

### Attention!

- Do not install on weak structures such as plaster walls and compressed wood boards when their thickness is less than 10 mm
- To prevent fire or electric shock due to leakage, please do not install it on metal walls
- Hanging area must be flat
- Wall mount must be placed in ambient temperature between 5°C and 40°C
- Ensure screw will not damage gas pipe, water pipe or wire inside of the wall

### Charging the battery

#### Information about charging the battery

### Attention!

Before you charge the battery, please switch the vacuum cleaner off. Please do not recharge immediately after using up the power. Please recharge when batteries be cooled for at least one hour. Please unplug the charger when the indicator light changes from red to green. Let the cleaner cool down for a while.

When the voltage is too low, in order to protect the battery, the vacuum cleaner will start its automatic power-off protection function, at this point you have to charge the vacuum cleaner. The battery pack can be pulled out and be charged separately or it can be charged when it is assembled in the whole machine and hanged in the hanger while the plug of the charger is inserted into the AC outlet. At this time, the indicator light on the battery pack shows “red”, it means that the vacuum cleaner is charging. The charging time is about 4-5 hours

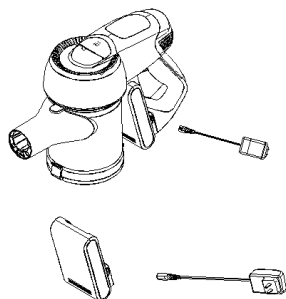

### Wall mount

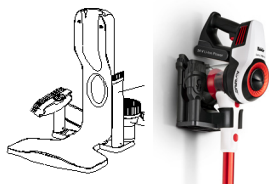

Install the wall mount with the provided screws and dowels. Now you can store your vacuum cleaner. The 2 in 1 tools and soft brush can be placed on the side of the wall mount.

### Operation

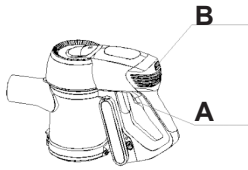

Press the on/off button **(A)** to start the appliance.  
To switch between low and high speed, press the button “I/II” **(B)**.

### Accessory

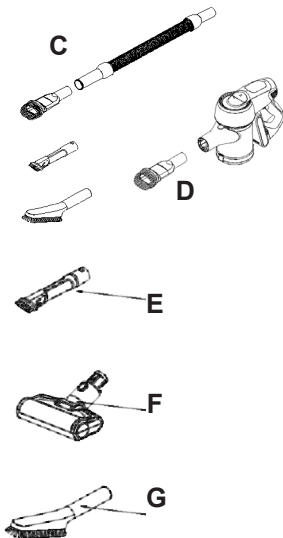

When you use the hand-held vacuum cleaner alone, you can connect the accessories directly if required or connect them through the tube.

**The electric power brushes only fit on the metallic tube and the hand held vacuum cleaner directly.**

The 2 in 1 sofa brush **(D)** is applicable to clean upholstered furniture and curtains.

With the 2 in 1 flat brush **(E)** you can clean slits, deep cracks and corners.

To clean mattresses and other large textile surfaces you may use the small electric power brush **(F)** (not included).

The soft brush **(G)** (not included) is particularly suitable for very sensitive surfaces like monitors, books and glass.

To clean places that are difficult to access, like the surface of cupboards, connect the soft brush with the joint adapter **(H)** (not included) and the flexible hose **(C)** (not included).



## Cleaning

### **Warning!**

Turn off the vacuum cleaner and unplug it before cleaning and maintenance. Thus, you may prevent unintentional operation of the appliance.

### **Attention!**

Do not use any cleaning agents, abrasives or alcohol. These may damage the external housing. Clean the device only with a dry or damp piece of cloth. Never clean the electric parts with water.

## Emptying the dust cup

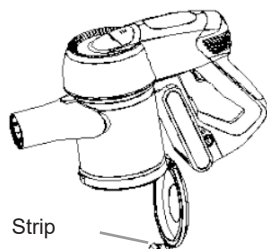

Strip

Open the dust cup by pulling the strip and then dispose the dirt. It is recommended to clean the dust cup every time after use. Therefore press the release button **(A)** of the hand held cleaner, rotate the dust cup clockwise to separate it from the body and pull the cup downwards.

Make sure that all parts are completely dried before reassembling.

Also check that the EPA Filter is not too soiled. This can lead to lower performance and even damage to your vacuum cleaner. If necessary, replace the filter.

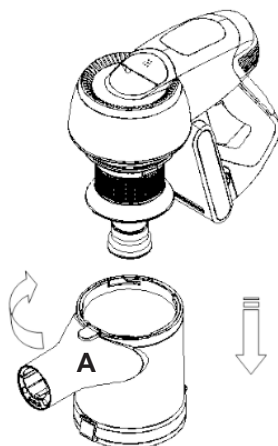

### **Note!**

Always ensure that all the filters are inserted before you use the vacuum cleaner.

**Cleaning the EPA filter**

Pull out the EPA filter at the upper lid **(A)**. Rotate the EPA filter clockwise to separate it from the lid. Wipe away the dust or replace the filter, if necessary.

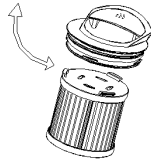
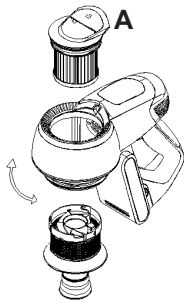
**Cleaning the electric power brush**

Push the release button **(B)** to remove the cover **(C)** at the roller brush side. Then take off one end of the roller brush from the slot as shown in the illustration and clean it. Remove hair and threads as well and let it dry completely. After cleaning or replacing, install it in reverse order.

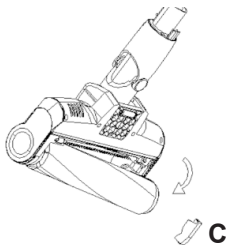
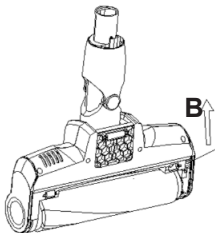

Dear Customer,  
Our products are subjected to stringent quality controls.  
If this appliance should nevertheless fail to function properly,  
this is a matter of regret for us. Before contacting our cus-  
tomer services, check to see if you can eliminate the problem  
yourself.



### Warning!

Turn off the appliance and unplug it before troubleshooting after cooling period. Thus, you may prevent unintentional operation of the appliance.



### Information!

Please contact our Hotline first, if you cannot troubleshoot a problem by yourself or in case of an intentional product return.

#### Hotline

**0121 706 5771**

#### Before calling, always have

the 7-digit product number with appliance/model name,  
e.g. **29 72 003** and the date of production, e.g. 2019-05,  
(you may find these information on the type label of the appliance.) or the 7-digit  
spare part number at hand.



### Attention!

Repairs and maintenance shall be carried out only by trained specialists (e.g. an authorized Victor service center). Use genuine Victor replacement parts for these purposes. Appliances that are repaired by unauthorized persons or that are not main-tained properly pose a risk for the user.



<b>Problem</b>	<b>Probable Cause</b>	<b>Remedy</b>
Appliance does not operate	Battery is empty	Charge battery
or appliance does not charge	Appliance is switched off	Switch on appliance
	No electricity at wall socket	Use other wall socket
Appliance does not vacuum dust	Dust container is full	Empty dust container
	Filter is dirty	Clean or replace the corresponding filter
	Nozzle or tube are clogged	Eliminate clogging. If necessary, use a wooden stick with a proper length to do this
	The power setting does not suit the flooring	Set the power to the setting suggested for the flooring
Appliance operates unusually loud	Sucked-in particles clogging in the air path	Remove particles. If necessary, use a wooden stick with a proper length to do this.

When the appliance has reached the end of its service life, in particular when malfunctions start occurring render the appliance unserviceable by pulling the mains plug out of the socket and cutting off the power cord.



Dispose of the appliance in accordance with the applicable environmental regulations for your country.

Do not dispose of electrical equipment with the household refuse.

The packaging of the appliance is made of recyclable materials. Sort the packaging material and recycle accordingly.



For information about recycling, please contact your local authorities or your retail dealer.

Unserviceable electrical and electronic appliances and batteries contain hazardous substances, which were previously necessary for the proper functioning and safety of the appliances.

Never dispose of unserviceable appliances or batteries with the household refuse!

In household refuse, or if handled incorrectly, these substances are hazardous to human health and the environment.

Unserviceable electrical and electronic appliances and batteries often contain valuable materials.

Dispose of batteries separately!

Make use of your local recycling facilities for recycling of electrical and electronic appliances and batteries.

This appliance fulfills the requirements of the 2012/19/EU – WEEE Directive.

**We offer a warranty under the following conditions for this appliance:**

1. Your reseller's residential address / company address shall be located in the EU or the appliance shall be purchased from an authorized reseller in the UK.
2. We guarantee to ensure that you may send the appliance to us free of charge and to repair the faults which have been reported within 24 months due to material or assembly errors that occur within 24 months (12 months for industrial and professional uses).  
Proper use of the appliance is a pre-requisite for fulfilling the warranty obligation. The warranty period begins with the date of sale.
3. Parts included in natural wear parts (drive belt, batteries, brushes, filters) are not covered under warranty.
4. Warranty claims shall be void in case of intervention or repair by persons who are not authorized us. In addition, aftermarket spare parts or accessories shall not be installed.
5. Warranty service consists of repair or replacement of defective parts. On-site repairs may only be requested for fixed large appliances. In order to document warranty claims, it is necessary to present the invoice or voucher with the date of purchase.
6. If the repair operation fails and the fault or defect can not be remedied after service, the appliance shall be replaced with an equivalent appliance. If a repair or replacement is not possible, you are entitled the right to return the appliance and to demand a refund of the sales value of the appliance. A fee may be requested for the period of use in case of a request for an exchange or refund of the sales value.
7. Warranty services do not cause an extension of the warranty period or start of a new warranty period. The warranty period for the parts installed inside the appliance ends with the end of the total warranty period of the appliance.
8. Contractual or statutory clauses for repair of faults remain in effect regardless of warranty terms.

**Applies as of July 1st, 2017**

---

**Victor Floorcare**

Unit 15 & 16 Ace Business  
Park Mackadown Lane  
Birmingham B33 0LD

Tel.: +44 (0)121 706 5771

[www.victorfloorcare.com](http://www.victorfloorcare.com)

[info@victorfloorcare.com](mailto:info@victorfloorcare.com)



© 2019 Victor Floorcare  
Rights to make changes are reserved.  
Subject to revision  
29 72 994 - 9905 en